

FINN•POWER

Bar Code Reader

for UC-crimping machines

- Speeds up retrieval of crimping parameters
- The possibility of human error decreases
- Supports quality control

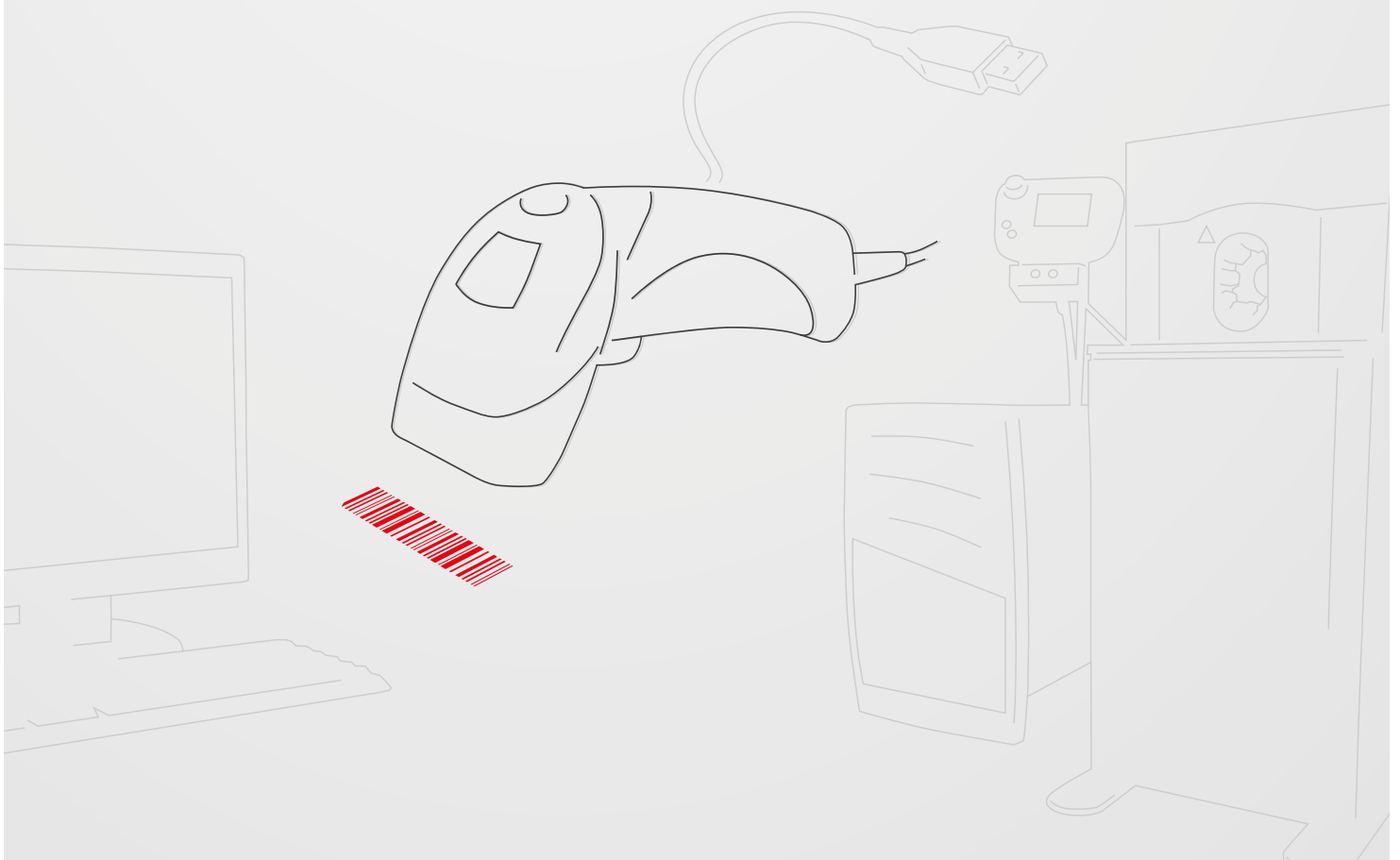

Operation diagram - normal mode

For basic production.

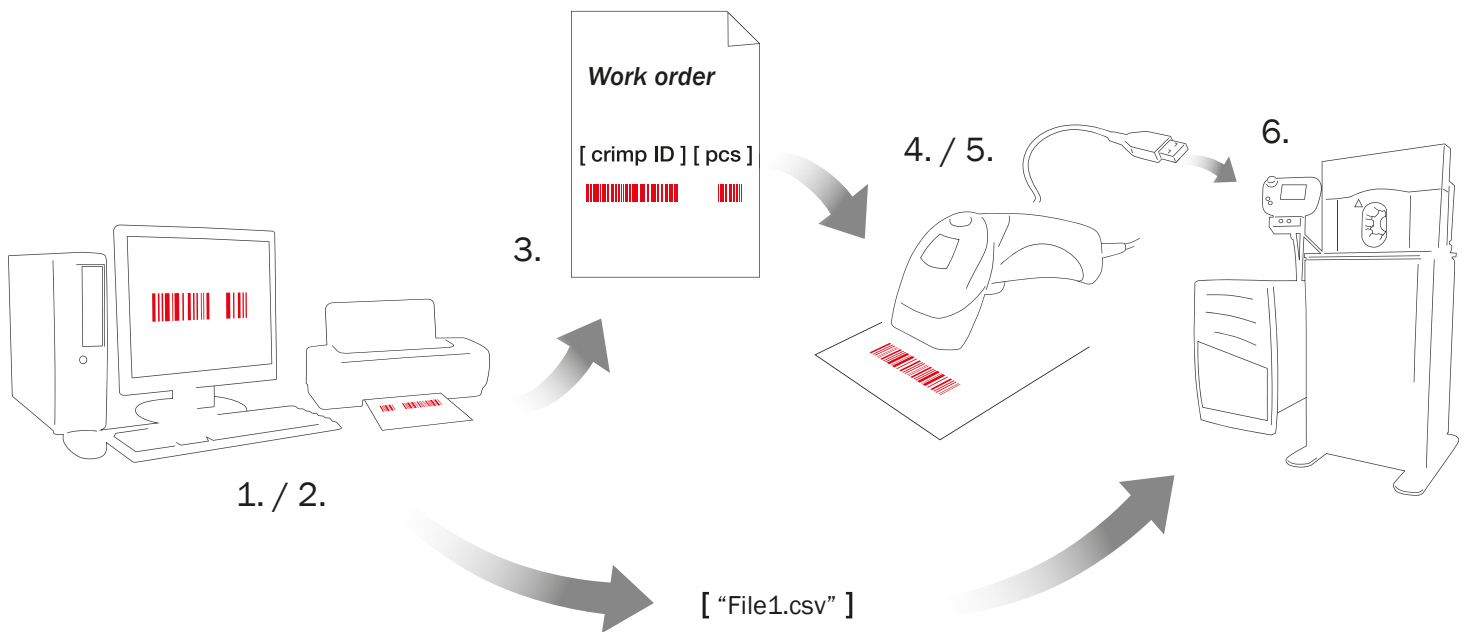

PREPARATION PHASE

1. Crimping parameters are saved on the computer ("File1.csv") and copied to the crimping machine via USB or ethernet.

START-UP PHASE

2. The order is entered on the computer.
3. The work order is printed for the assembly manufacturer.

PRODUCTION PHASE

4. The bar code is read with BCR and UC retrieves the memorized crimping information ("File1.csv").
5. The number of items is read from secondary bar code or entered manually.
6. Manufacture of assembly.

New orders start at step 2.

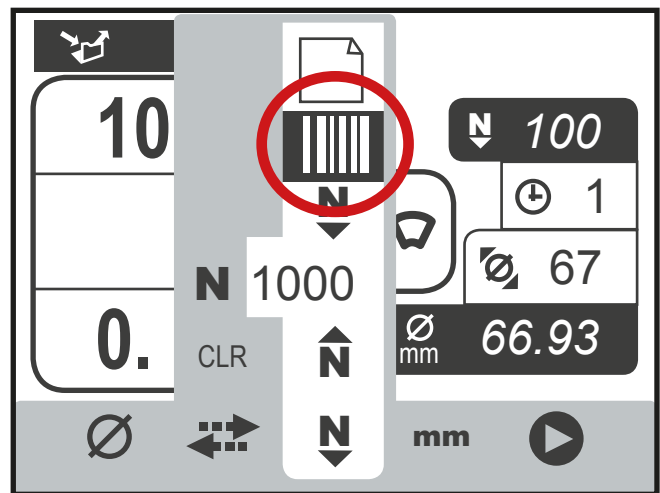

Display image

Operation diagram - work queue mode

For advanced, ERP-controlled production.

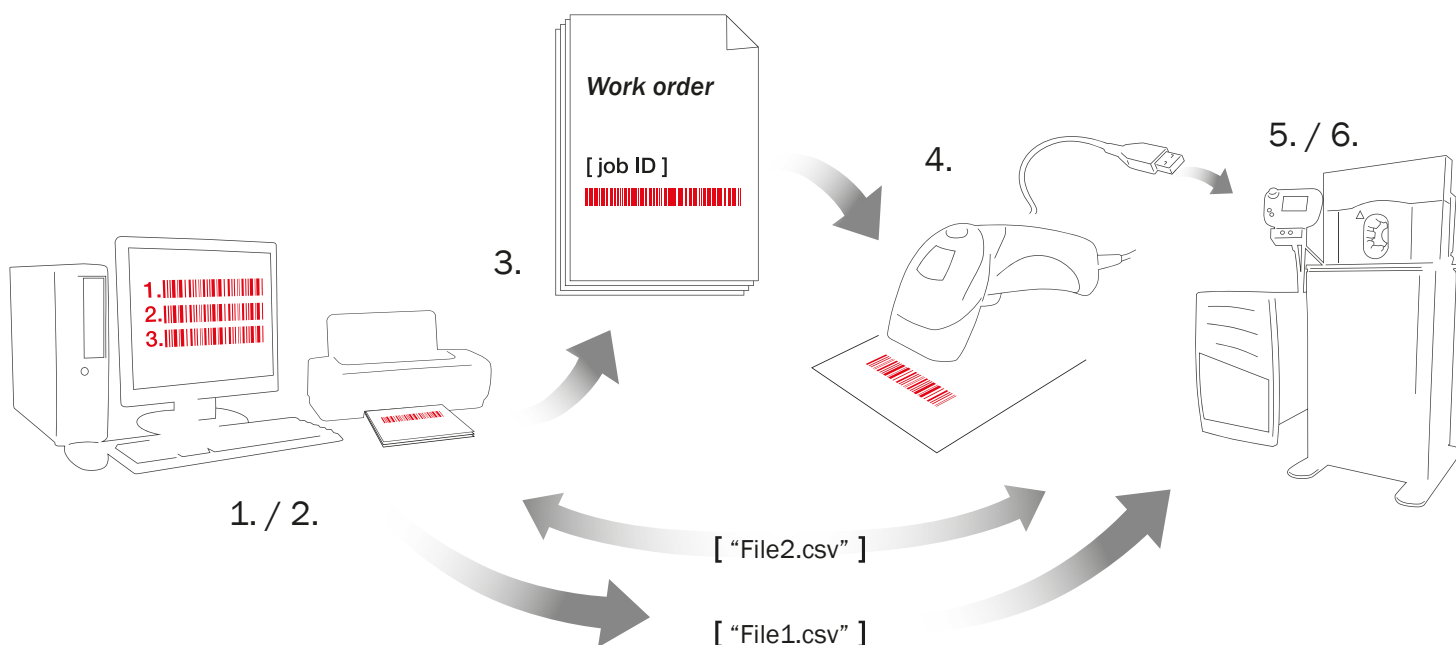

PREPARATION PHASE

1. Crimping parameters are saved on the computer ("File1.csv") and copied to the crimping machine via ethernet.

START-UP PHASE

2. The order is entered on the computer and placed in a work queue.
3. The orders are printed for the assembly manufacturer (barcodes).

PRODUCTION PHASE

4. The work order bar code is read with BCR.
5. The drive uses the "File2.csv"-file to retrieve the memorized crimping parameters.
6. Manufacture of assembly.

New orders start at step 2 or 4.

WORK MONITORING ON PC

Real-time monitoring of manufacturing information from "File1.csv".

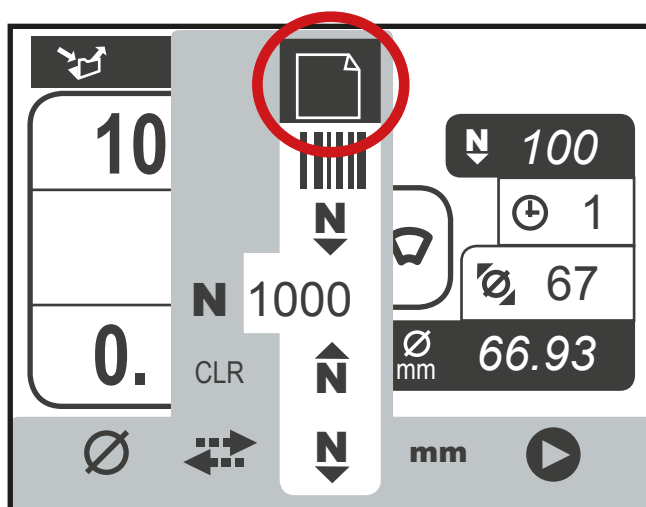

Display image

Benefits

- Speeds up retrieval of crimping parameters
- The possibility of human error decreases
- Supports quality control

Package contents

- USB-connected bar code reader
- Option activation

System requirements

- The bar codes are created with universal barcode generator software (not included)
- Bar code type 'Code 39'

Bar code reader features

- Supports USB-keyboard (HID keyboard)
- Supports Linux operating system drives



Lillbacka Powerco Oy
Tel.: +358 10 347 7400
Fax: +358 6 485 4400
P.O.Box 1
FI-62301 Härmä, Finland

Sales
powerco@lillbacka.com
Tel. +358 10 347 7401
Fax. +358 6 485 4400

Support
customer.support@lillbacka.com
(spare parts, service, training)
Tel. +358 10 347 7410
Fax. +358 6 485 4403

